

SPECIFICATIONS

Heating Edge™
Hot Water Performance Ratings

Flow Rate GPM	PD in ft of H ₂ O	Average Water Temperature (BTU/hr/ft @AWT in °F)														
		90°F	100°F	110°F	120°F	130°F	140°F	150°F	160°F	170°F	180°F	190°F	200°F	210°F		
		1	0.0044	130	205	290	385	460	546	637	718	813	911	1009	1113	1215
		4	0.0481	134	224*	314*	412*	516*	626*	741*	862*	976*	1115*	1249*	1386*	1526
		1	0.0088	101	165*	226*	289*	356*	426*	498*	572*	647*	725*	805*	885*	970
		4	0.0962	142	201*	271*	341*	415*	492*	569*	648*	728*	811*	894*	979*	1064
		1	0.0088	99	162	221	283	349	418	488	561	634	710	788	867	957
		4	0.0962	135	195	259	305	380	464	552	634	710	793	874	959	1039
		1	0.0044	75	127	169	208	260	311	362	408	470	524	576	629	685
		4	0.0481	85	140	203	265	334	410	472	536	599	662	723	788	850

Performance Notes: • All ratings include a 15% heating effect factor • Materials of construction include all aluminum "patented" fins at 47.3 per LF, mechanically bonded to two 3/4" (075) type L copper tubes ("Coil Block") covered by a 20 gauge perforated, painted cover all mounted to a backplate. Please see dimensional drawing for fin shape and dimensions • EAT=65°F • Pressure drop in feet of H₂O per LF.



Where marked* Heating Edge (HE2) output is based on performance tests witnessed by BSRIA. The test data can be verified on the BSRIA website (report 55944/2). This includes calibration information. The catalogue data above is presented in accordance with the American IBR laboratory testing protocol for baseboard heating. This allows a 15% heating effect factor to be applied to the test values.

Dimensions Product Accessories

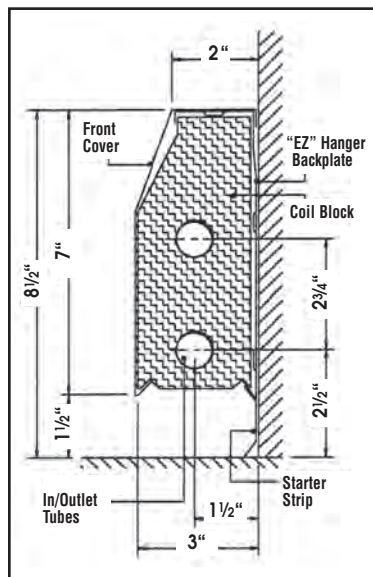

HE2 Has a perforated cover making it childproof and aesthetically pleasing
Available lengths: 2' 3' 4' 5' 6' 7' 8'

HE-TK The trim kit includes the cover, the back plate and starter strip.
Available lengths: 2' 3' 4' 5' 6' 7' 8'

IC90W
90° Inside Corner

OC90W
90° Outside Corner

SW
Splicer
2", 3", 4", 6"

IC135W
135° Inside Corner

OC135W
135° Outside Corner

EC12W
12" End Cap
left or right

EC6W
6" End Cap
left or right



**Model
HE 2**

- High capacity
- Easy to install, rust resistant and easy to clean
- Available in a variety of lengths from 2 ft. up to 8 ft.
- Attractive perforated cover design
- Designed to deliver quiet comfort with performance and style
- New enhanced scrub board fin design for maximum airflow
- Superior low temperature performance range

March 1, 2012

Heating Edge delivers high performance in style, and at low temperature ranges

High efficiency equipment requires a high efficiency heating element...

Geothermal heat pumps, solar thermal collectors and condensing boilers are all great ways to save energy and reduce fossil fuel usage. All three achieve their highest efficiencies when delivering low temperature water. The challenge faced when it comes to heating effectively with traditional baseboard is that supply water temperatures need to be at least 140°F in order to deliver enough BTUH's to sufficiently heat a space at design temperature. Not so with the Heating Edge HE2 high capacity hybrid element. Because the HE2 has the unique two-pipe design, it is able to deliver comparable BTUH's using 90°F water, all in an attractive package.

Heating Edge is perfect for use with the following low temperature heat generators:

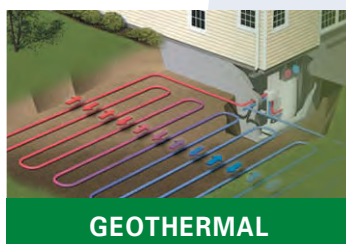

GEOTHERMAL



SOLAR THERMAL



CONDENSING BOILERS

Heating Edge™ Features and Benefits

- ▲ **Unique Coil Block System**
Convection and radiant combined
 - Cover contact to Coil Block provides larger Radiant Surface combined with Conductive Chimneys created by Folded Fins
 - **New Enhanced Fin Design**
more surface area; folded in front and back
 - Turbulated fin surface
 - Deeper collars for maximum mechanical bond
 - Extra hold off fold to prevent nesting
 - Slightly different shape to maximize turbulated air flow
 - ◆ **Two Pipe Design**
high capacity outputs; variable piping options
 - The only two pipe reverse return product available
 - Allows for a variety of piping methods and capacity enhancements (please refer to back cover for performance table)
 - **Three Piece Design**
 - Eliminates all carriers, brackets, cradles, damper, damper vents and miscellaneous hardware resulting in quiet comfort
 - **Perforated Cover Design**
 - Perforated holes of less than 1/4" prevent foreign objects from entering Coil Block
 - Crayons, pencils and pens will not slip through
 - Ideal for children's rooms
- Easy to Clean**
- Simply cleaned with the pass of a vacuum cleaner
 - The healthier alternative
- Rust Resistant**
- Coil Block constructed of Aluminum and Copper
 - Cover and "EZ Hanger" Backplate constructed of 20 gauge steel with a 2-part rust resistant paint with all edges and openings finished and coated
 - Withstands the rigors of most bathroom applications

Rugged Exterior

Contact with Coil Block provides added support and rigidity to ensure cover to be dent resistant making the Heating Edge ideal for:

- | | | | |
|------------|----------------------------|---------------|------------------|
| Offices | Dormitories | Restaurants | Children's Rooms |
| Hospitals | Schools | Nursing Homes | Lobbies |
| Apartments | Assisted Living Facilities | | |

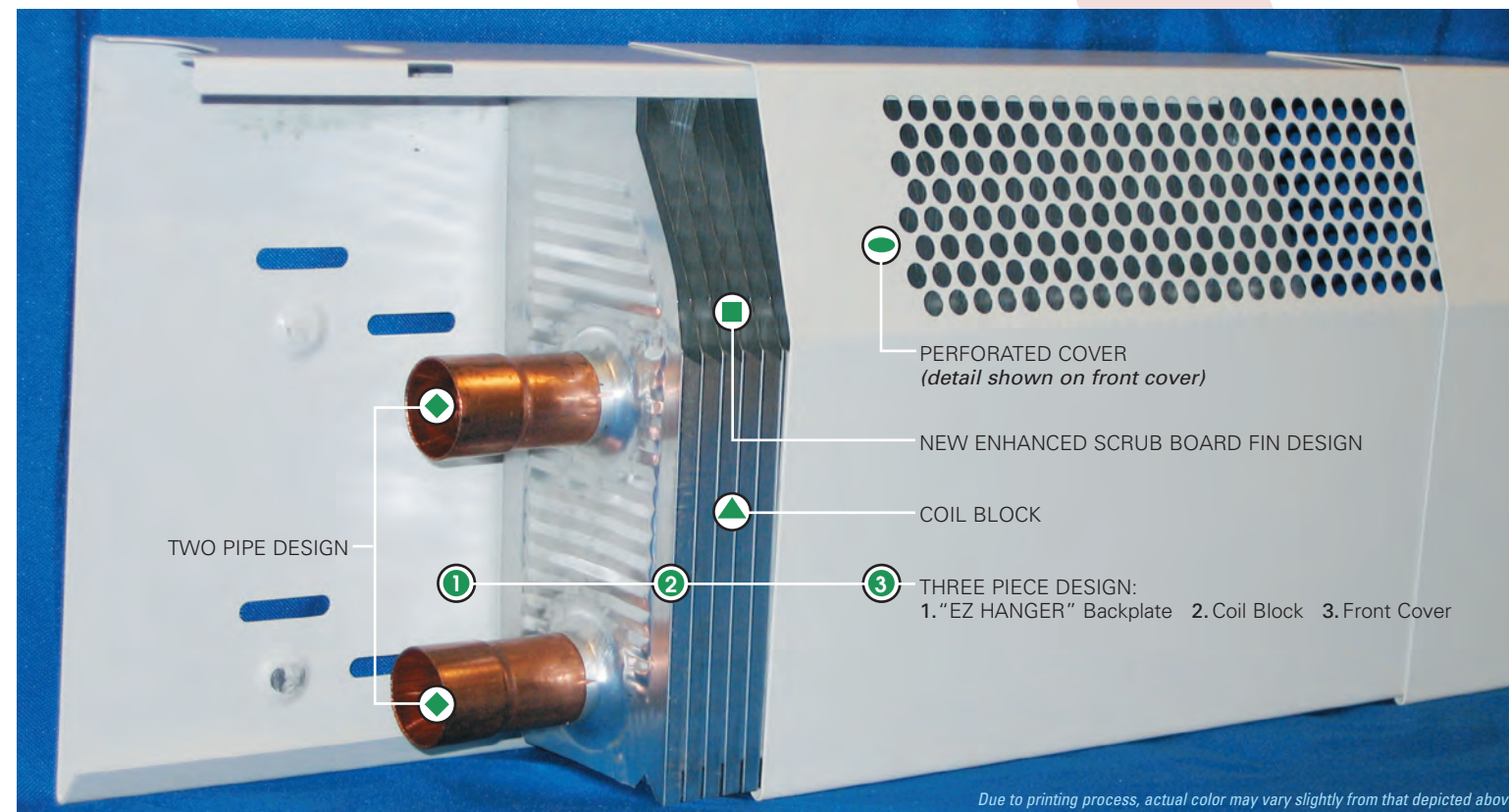

Installs in a "Snap" 1-2-3

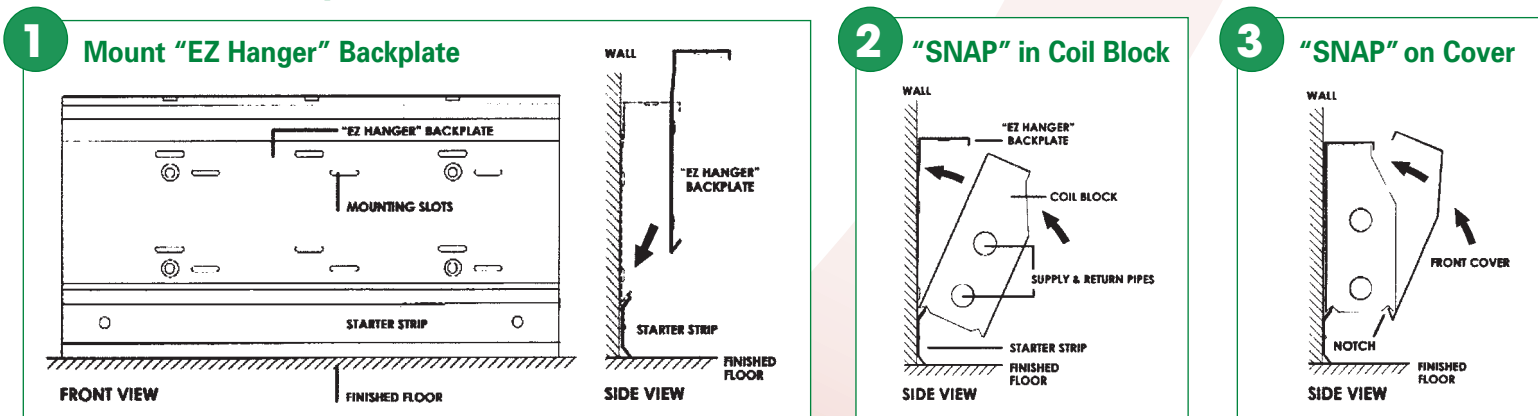

Mount "EZ Hanger" Backplate – fasten to wall through mounting slots provided (6 per foot). When installing on top of finish floor, utilize starter strip to maintain the minimum 1 3/4" air gap.

"Snap" in Coil Block – engage back notch onto lower lip of the "EZ Hanger" Backplate and pivot the Coil Block towards the wall until it "Snaps" into place.

"Snap" on Cover – after piping connections are completed, place lower lip of cover into front notch in the Coil Block and pivot towards the wall until it "Snaps" over the "EZ Hanger" Backplate.